

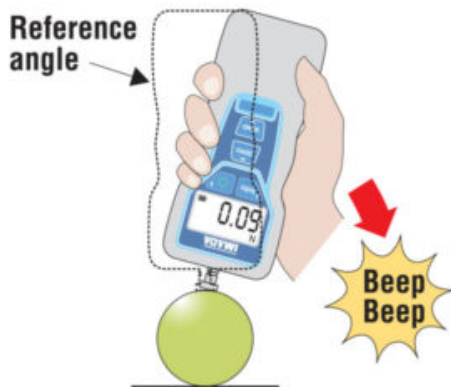

CALL TOLL FREE **1-800-373-9989**

Vector Force Gauge

Tilt Sensor Improves Test Accuracy

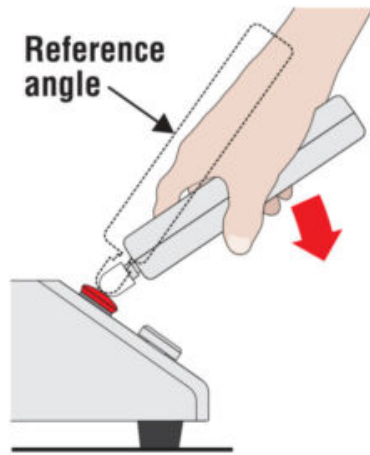

Standard Features

- Tilt Sensor: Alerts user to deviation from the reference angle
- Backlit LCD display with user-friendly menus
- Ergonomic, durable, heavy-duty metal construction
- 30,000/sec ultra-high sampling rate
- 1,000 Data memory; automatically calculates Max, Min, Avg statistics

- USB and RS-232C output
- Selectable real time or peak mode operation
- Setting security lock prevents accidental changes
- Overload capacity 200% F.S.; Display flashes at overload limit
- Runs on internal Ni-MH batteries (user replaceable) or AC adapter; Charges with USB port or portable charger

Tilt Sensor Helps users performing handheld measurements to push or pull at a consistent angle, improving measurement accuracy. The tilt alarm has three degrees of sensitivity 4°, 8° or 18° from the reference angle.

RANGES

<u>Model</u>		DSV-0.4A	DSV-1A	DSV-4A	DSV-11A	DSV-44A
	Ounces	7.000 (0.001 ozf)	17.00 (0.01 ozf)	-	-	-
	Pounds	-	-	4.400 (0.001 lbf)	11.00 (0.01 lbf)	44.00 (0.01 lbf)
Capacity (Resolution)	Grams	200.0 (0.1 gf)	500.0 (0.1 gf)	-	-	-
	Kilograms	-	-	2.000 (0.001 kgf)	5.000 (0.001 kgf)	20.00 (0.01 kgf)
	Newtons	2.000 (0.001 N)	5.000 (0.001 N)	20.00 (0.01 N)	50.00 (0.01 N)	200.0 (0.01 N)

SPECS

DSV Specifications	
Tilt Alarm	OFF, Strict (4°), Normal (8°) or Loose (18°)
Accuracy	± 0.2% F.S., ± 1 LSD
Selectable Units	lbf(ozf), kgf(gf) or Newtons
Display	4 digit backlit LCD
Overload Capacity	Approx. 200% of F.S.
Overload Alarm	Audible alarm at 90% of capacity; Audible alarm and indicator flashes beyond 110% of F.S.
Sampling Rate	30,000/second
Internal Memory	1,000 data with statistics
Battery Life	Approx. 30 hours backlight off Approx. 14 hours backlight on 4.5 hours required for full charge
Battery Indicator	Battery icon displays three levels of charge
Setpoints	Programmable high/low setpoints with OK indicator
Outputs	USB, RS-232C

Operating Temp.	32° to 100°F (0° to 40°C)
Accessories Included	AC adapter, Attachments (hook, flat tip, conical tip, chisel tip, notched tip, extension shaft), Carrying Case

SOFTWARE

Force Logger (optional)

Available to users who need to collect peak data. Please inquire.

SW-1X Data Acquisition Software (optional)

Capture and analyze real-time data from any Imada gauge with a USB or RS-232 port directly into any Windows program. Log measurements and generate a profile graph plus statistical information. Control gauge functions from your computer.

DB-1X Data Input Button (optional)

DB-1X is a compact, one channel interface that enables users to send measurement data to a PC running SW-1X, Imada data acquisition software or other software. The data input button 'zeros' the gauge after sending data to the PC eliminating the need to reset manually.

IMADA, Incorporated 3100 Dundee Rd., Suite 707, Northbrook, IL 60062 © Copyright 2019
ISO 9001 Registered & ISO/IEC 17025 Accredited Phone: 847-562-0834 Fax: 847-562-0839